

NATIONAL INSTITUTE OF CIRCUS ARTS

The Guang Rong OAM National Circus Centre

TECHNICAL SPECIFICATIONS



STAGE:

Stage Description:

Our NCC training facility is a 12-metre-high 35m x 35m Circus training venue that is transformed into a professional performance space with various seating arrangements available depending on requirements.

When in show mode it consists of 200 seats in the raked auditorium format.

The stage is an open stage. No proscenium or flown scenery capabilities.

There are 3x50mm box trusses running across stage suitable for rigging Circus apparatus.

The stage floor slightly raised at a height of 150mm and made from 19mm Plywood. Please note, there is no nailing or screwing to the floor permitted.

Stage Dimensions:

Main stage 12m x 8.4m

Setting Line: Front Edge of Stage

Height of Stage 120mm

Distance From:

SL to OP Wall. 1020mm

SR to PS Wall 1100mm

US Edge to Back Wall 3000mm

(SL = Setting Line, CL = Centre Line)

Auditorium:

Seating capacity: **200**

12 Removable Seats to accommodate wheelchairs.

A stage extension is available at an extra charge. This increases the stage depth by 1.2m

*Please contact Technical Manager for further information.

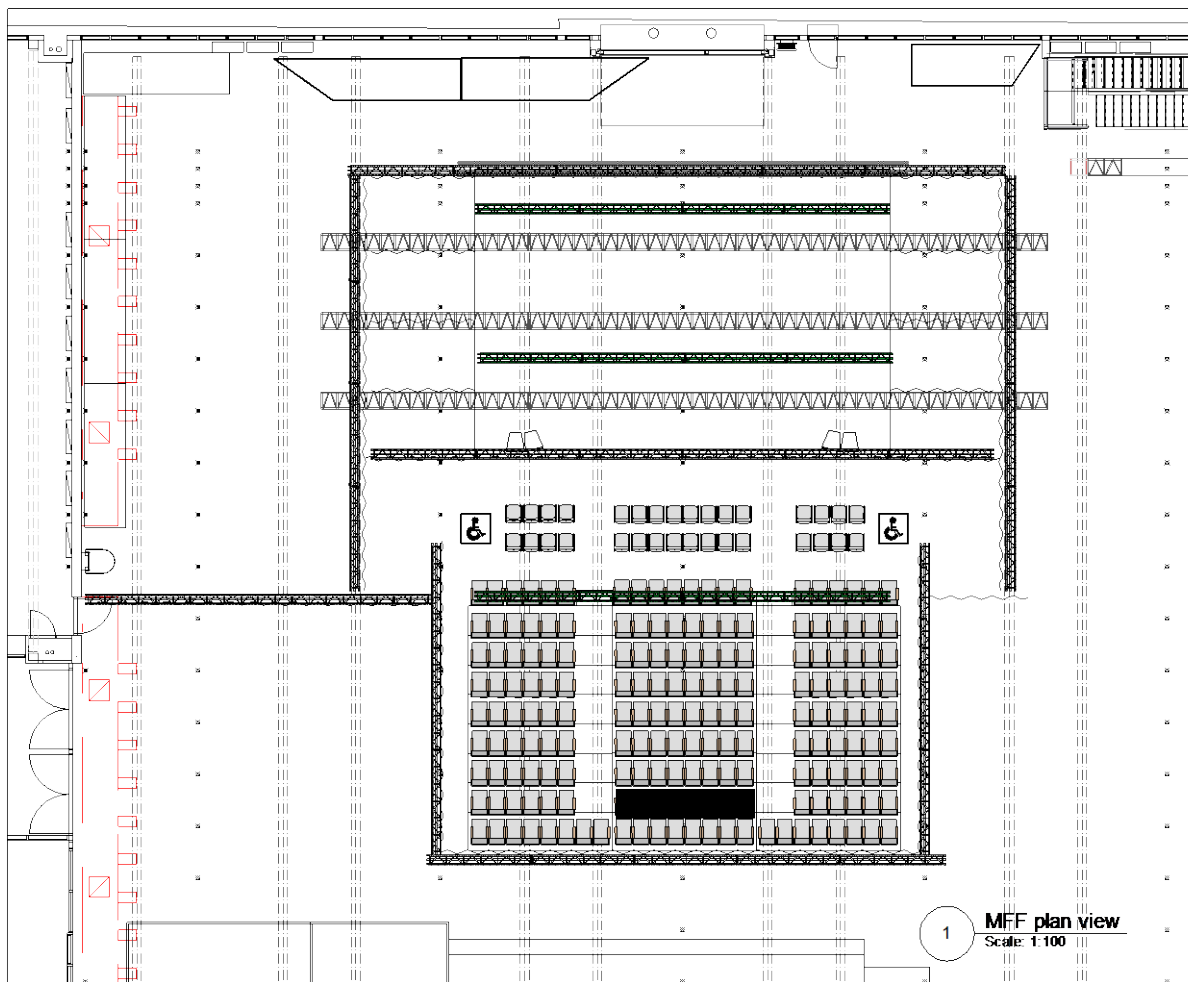

MFF plan view
Scale: 1:100



Address
41 Green St
Prahran 3181
VICTORIA
Ph: 92146975
www.nica.com.au

Audience Capacity = 200



Music: NICA - NCC

Plan

Purpose: Melbourne Fringe Festival

Date: 9th of Feb 2023

Notes

Please check all critical dimensions on site.
If or any other information please
contact Production Office (92146541)

Version	1	Scale	1:100 @ A3
Drawn by	Kaleb. H	Checked	Scott. G

Rigging & Overhead Structures:

Numerous possibilities exist for Circus rigging. Through consultation with Technical Director
Catwalks at 11.5m
3 x Box Truss above stage at 11m
1 x Box Truss FOH.
Aerial Anchor Points @ 1000mm from SL & SR stage edge (Refer to plan)

Fly System:

1 x HME Performance Winch. Operating Position - US PS.
Aerialist Counterweight ladder possible through consultation

Drapery:

3 Legs 3.3m x 8m Black 450GSM wool. Each side of stage
Tab Track 15m set at US edge

Access Equipment:

EWP – Up-Lift 14.5m (EWP Licence required)
Ladders: 1 x A Frame Ladder 4m.
1 x A Frame ladder 1.5m

Loading Dock: Access is via Green St through our Workshop area
Door: 3100 (H) X 3000 (W)

LIGHTING:

Lighting desk: ETC Ion Xe Console (4 Universe)
House Rig run on Universe A
LEDs and Intelligent fixtures run on across A&B

Control Position:

Rear of Auditorium seating (8 Seats removed).

Lighting Bar Positions	Dist. from SL.	Truss length.
Line #1 FOH Truss (Above Row 3).	4m	9m
Line #2 (Tri-Truss).	0m	9m
Line #3 (Tri Truss).	7m	9m
Line #54 Tab track Truss	8.4m.	15m

Lighting Boom Positions

DSL
MSL
USL

DSR
MSR
USR

Cabling: NICA has limited stock of 240v extension cables and DMX cables to accommodate the venue's standard lighting rig. Any additional equipment will require additional cable stock to be sourced.

Haze

If you are supplying your own stage hazer machines ensure smoke isolation of building,
Only water-based haze fluid is permitted to be used.

AUDIO:

Venue contains Soundsystem with playback capability appropriate for venue

Console & Control Position:

Allan and Heath sq-7 Console is fixed in position at the Operating Position at Rear of Auditorium seating (8 Seats removed at back row).

It cannot be moved or utilised in another location in the venue.

Speakers – FOH speakers are positioned at DSL & DSR corners of stage hung at approx. 4 metres.

FOH Speakers Meyer CQ-1

Subs JBL PRX718XLF

Foldback EV SXA

Microphones

2 wireless hand-held

2x belt pack mics

Assortment of corded mics

Audio Cable

NICA has limited stock of 3-pin XLR cable in various lengths. There is also a limited stock of various audio adapters and connectors. All external equipment that may require specific adapters or connectors (i.e., instrument leads) are to be supplied by the hirer.

Notes:

Additional audio equipment required may be available by prior arrangement with Technical Management at an additional charge.

AUDIO VISUAL:

Projector Position: FOH Truss. Centre

Operating Position: Tech Desk

Projectors:

Type	Detail / Accessories	Total
Barco c1mr 10+	w/ remote and CLD (2.2-4.4:1) lens and 15amp IEC. 4x clamps.	1
Barco c1mr 10+	w/ remote and 1.6-2.4:1 short throw lens. [projector installed in movement studio. Remote in office AV draw] 15amp IEC missing	1

Screens:

Cyclorama 15m x 8m

Talkback

Master Unit	Radiocom BTR-800 Base Station
Total headsets	5 x Jands ESHI headsets
Total comms packs (wired)	5 x radiocom TR-800 radio belt pack

Production Facilities:

Greenroom/Production Kitchen

Tea/Coffee Facilities.	Yes
Fridge/Microwave.	Yes
Microwave.	Yes
Running Water.	Yes

Dressing Rooms

Located upstairs above Production Office SL
Capacity 12

Laundry

Washing Machine	Yes x1
Dryer	No
Drying Room	No
Iron Ironing board	Yes
Clothes Steamer	Yes
Clothes Rack	Yes

Note Access to Laundry is Restricted after hours

Stage Door

Stage Door is located along the side of NCC access via Green St next to the loading dock
Access during bump-in/out is controlled by NICA production team
Venue staff take no responsibility for Stage Door security during hire.

Warm Up Space:

There is a large space PS approx. 10mx8m suitable for acrobatic warm up. Including acromat tumble mats and aerial rigging points.

VENUE:

Venue Address: 39-59 Green St Prahran 3181

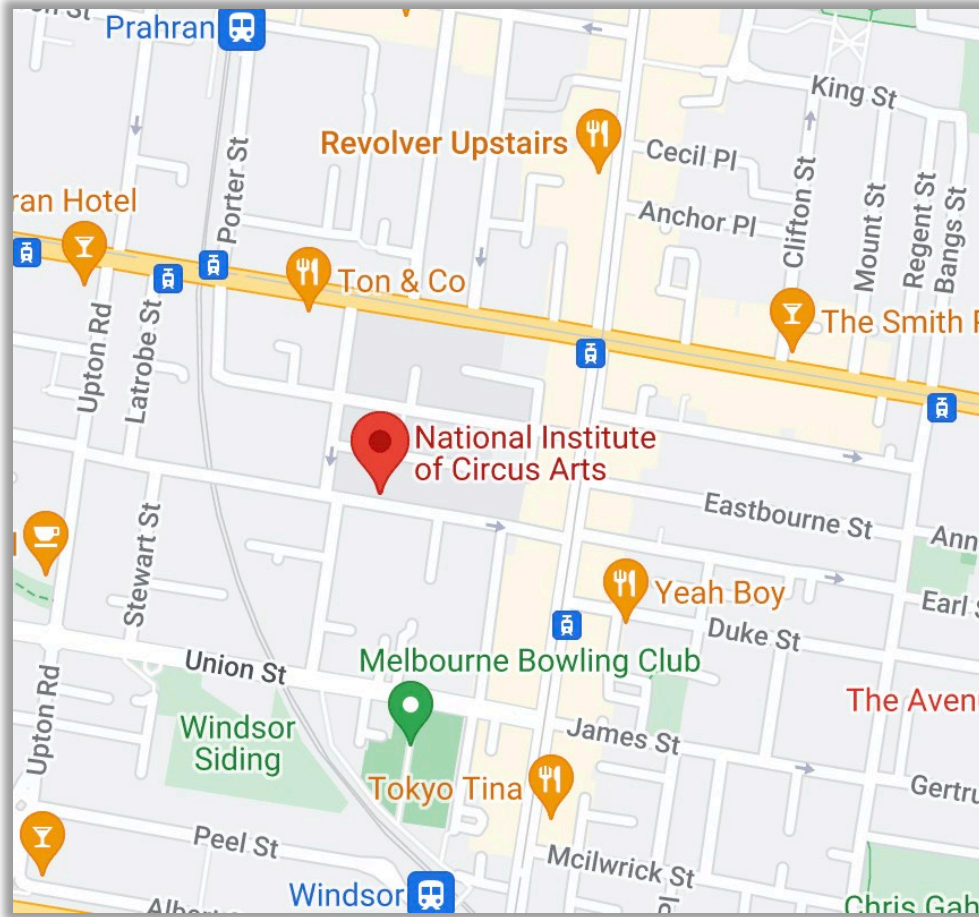

NICA Production Manager: Mr. Scott Grayland

Phone number: (03) 9214 6404

Email address: SGrayland@swin.edu.au

Website: <https://www.nica.com.au>

