

NATIONAL INSTITUTE OF CIRCUS ARTS

Movement Studio

TECHNICAL SPECIFICATIONS

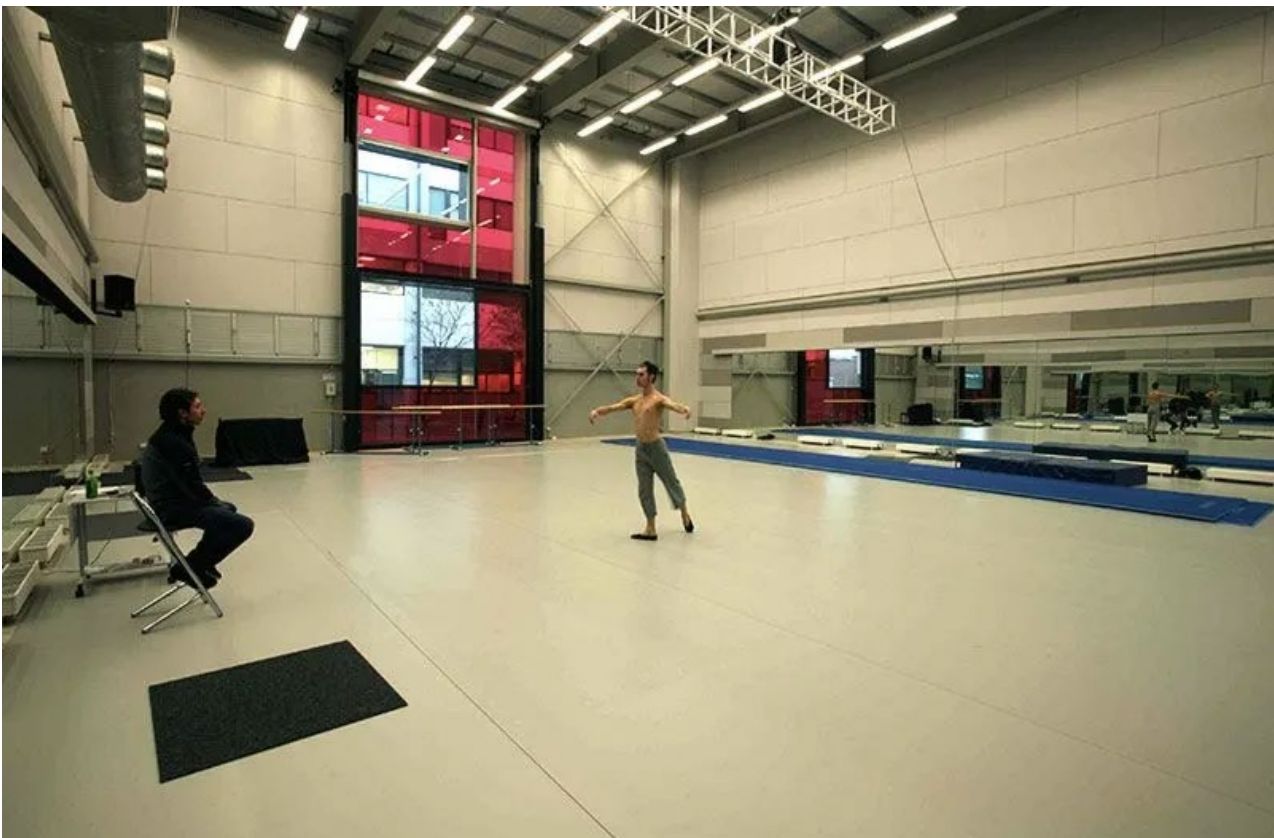

STAGE:

Stage Description:

NICA's spacious Movement Studio is a 10-metre-high 15m x 16m Circus training venue that is transformed into a performance space with various seating arrangements available depending on requirements.

The space has a high ceiling, Tarkett floor, aerial rigging, full length mirrors, portable ballet barres, air conditioning and a sound system.

When in show mode it has a seating capacity of 80 in a simple raked rostra format

The stage is an open stage. No proscenium or flown scenery capabilities.

There is 50mm box trusses above the playing area suitable for rigging Circus apparatus.

The room also contains

- Mirrored walls East and West - East wall with tabbed curtains
- Ballet barres
- Tarkett dance floor – Please note: Use of glass not allowed in this room. Any items that could perforate the surface must be protected (e.g., carpet squares under chair feet)
- 3 phase power – 2 x outlet at ground level, 4 in the ceiling

Stage Dimensions:

Main stage 8m x 8m

Distance From:

SL to OP Wall. 3.5m

SR to PS Wall 3.5m

US Edge to Back Wall 2m

Auditorium:

Seating capacity: **80**

8 Removable Seats to accommodate wheelchairs.

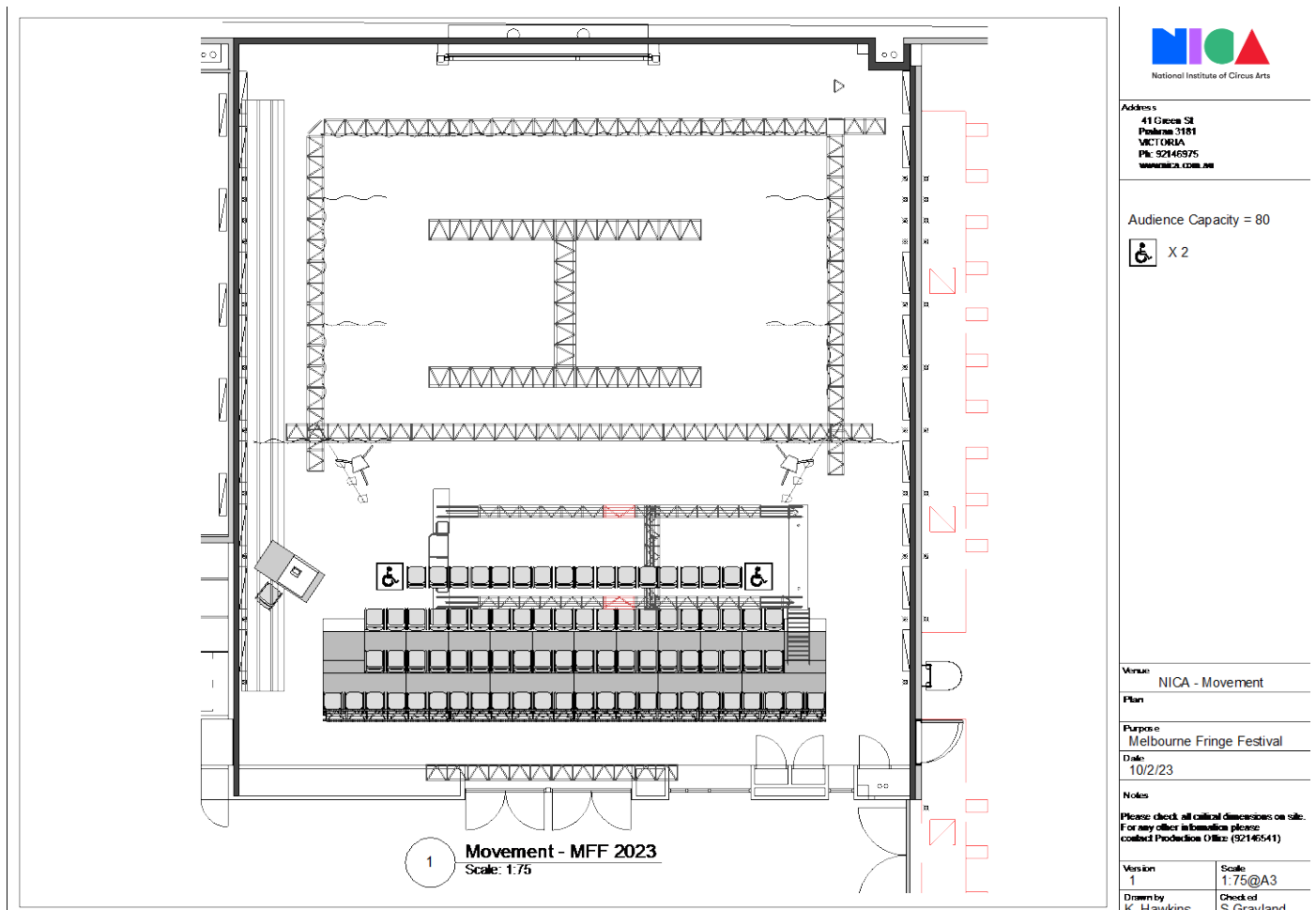

Rigging & Overhead Structures:

Numerous possibilities exist for Circus rigging. Through consultation with Technical Director 500mm Box Truss is fixed above stage in an 'H' layout at 10m. Refer to plan

1 x Box Truss FOH.

Aerial Anchor Points @ SL

Drapery:

3 Legs 1.5m x 8m Black 450GSM wool. Each side of stage

Tab Track 12m set at US edge

Access Equipment:

EWP – Up-Lift 14.5m (EWP Licence required)

Ladders: 1 x A Frame Ladder 4m.

1 x A Frame ladder 1.5m

Loading Dock: Access is via Green St through our Workshop area

Door: 3100 (H) X 3000 (W)

LIGHTING:

Venue contains a Basic theatrical lighting package available with venue operator. Set on rectangular trussing system at perimeter of stage area including Lx floor booms.

Lighting desk: LSC MantaLite (24 Channels)

Control Position:

In DSR Rear of Auditorium seating (8 Seats removed).

Lighting Bar Positions

Dist. from SL.

Truss length.

FOH Truss

8m

6m

Stage Truss

Set on rectangular trussing system at perimeter of stage area. See Plan

Lighting Boom Positions

DSL

MSL

DSR

MSR

Cabling: NICA has limited stock of 240v extension cables and DMX cables to accommodate the venue's standard lighting rig. Any additional equipment will require additional cable stock to be sourced.

Haze

If you are supplying your own stage hazer machines ensure smoke isolation of building, Only water-based haze fluid is permitted to be used

AUDIO:

Venue contains Soundsystem with playback capability appropriate for venue.

Console & Control Position:

Tech table DSR

Mixer Yamaha MG24/14 FX mixer

Yamaha MG102C mixer

FOH Speakers Mackie SRM450

Foldback Yamaha DBR10

Console & Control Position:

Microphones

2 wireless handhelds

2x belt pack mics

Assortment of corded mics

Audio Cable

NICA has limited stock of 3-pin XLR cable in various lengths. There is also a limited stock of various audio adapters and connectors. All external equipment that may require specific adapters or connectors (i.e., instrument leads) are to be supplied by the hirer.

Notes:

Additional audio equipment required may be available by prior arrangement with Technical Management at an additional charge.

AUDIO VISUAL:

Projector Position: FOH Truss. Centre

Operating Position: Tech Desk

Projectors:

Type	Detail / Accessories	Total
Barco clmr 10+	w/ remote and CLD (2.2-4.4:1) lens and 15amp IEC. 4x clamps.	1
Barco clmr 10+	w/ remote and 1.6-2.4:1 short throw lens. [projector installed in movement studio. Remote in office AV draw] 15amp IEC missing	1

Screens:

Cyclorama 15m x 8m. Through consultation with Technical Director

Projector Screen 4:3 ratio (Hung) 3.5mx2.7m

Production Facilities:

Greenroom/Production Kitchen

Tea/Coffee Facilities. Yes
Fridge/Microwave. Yes
Microwave. Yes
Running Water. Yes

Dressing Rooms

Located upstairs above Production Office SL
Capacity 12

Laundry

Washing Machine Yes x1
Dryer No
Drying Room No
Iron Ironing board Yes
Clothes Steamer Yes
Clothes Rack Yes

Note Access to Laundry is Restricted after hours

Stage Door

Stage Door is located along the side of NCC access via Green St next to the loading dock
Access during bump-in/out is controlled by NICA production team
Venue staff take no responsibility for Stage Door security during hire.

Warm Up Space:

There is a large space PS approx. 10mx8m suitable for acrobatic warm up. Including acromat
tumble mats and aerial rigging points

VENUE:

Venue Address: 39-59 Green St Prahran 3181

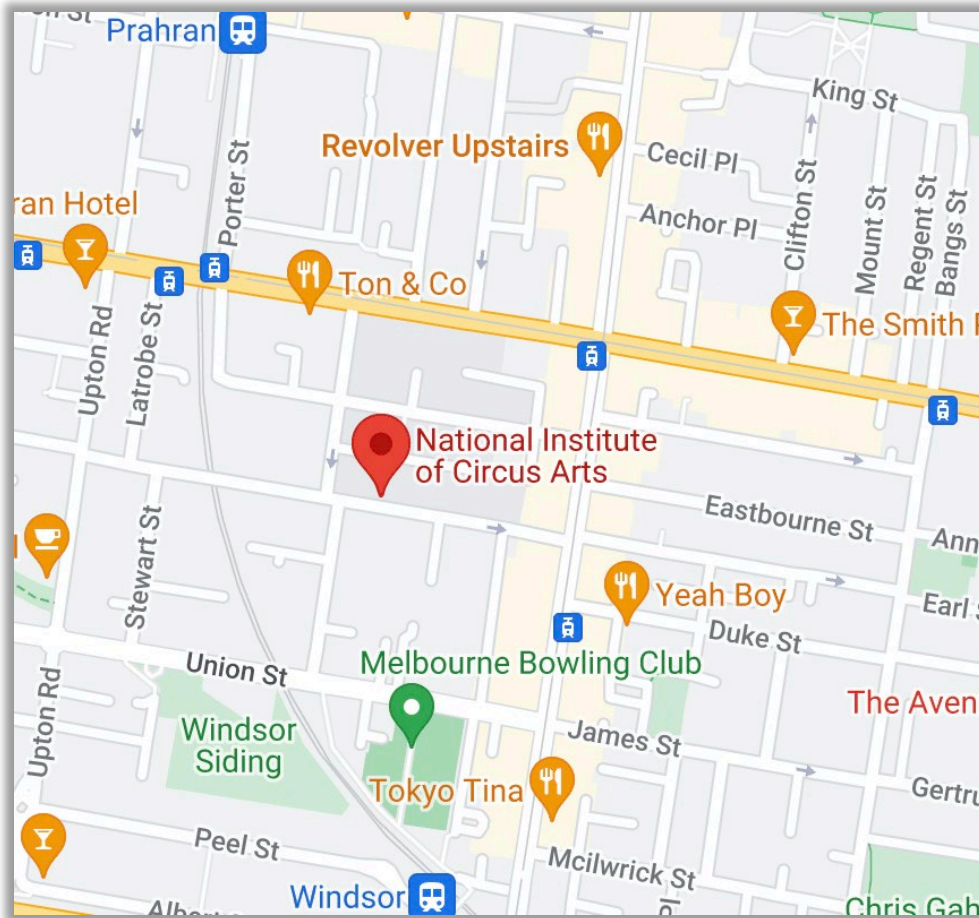

NICA Production Manager: Mr. Scott Grayland
Phone number: (03) 9214 6404
Email address:
SGrayland@swin.edu.au
Website: www.nica.com.au

